

HEAD TUBE(頭管)

堆積高度(STACK HEIGHT)=9.5±1mm

可選配之上塞高度
(TOP COVER IS OPTIONAL)

型號(MODEL NO.): H397

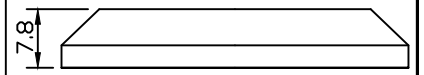

型號(MODEL NO.): H397M

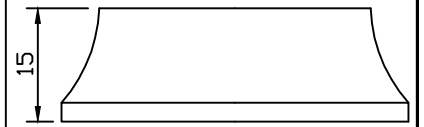

型號(MODEL NO.): H397H

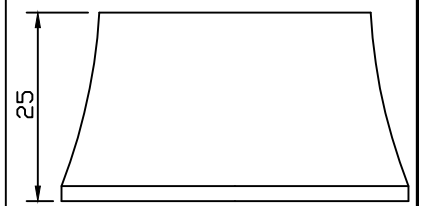

NO.	零件名稱 PART NAME	材質 MATERIAL	圖號 DRAWING NO.	台量 Q'TY	尺寸 DIM. DESCRIPTION
1	O形圈 O-RING	橡膠 NBR	120-8	1	ID28.5xø2
2	上塞 TOP COVER	鋁合金 6061/T6	51-3	1	1-1/8"
3	防塵蓋 UPPER WATER SEAL	橡膠 NBR	273-0	1	
4	鋁斜管 COMPRESSION RING	鋁合金 6061/T6	51-2	1	1-1/8"
5	密封式軸承 A. C. SEALED BEARING	軸承鋼 SUJ2	NHB-6B	1	OD41.8x45°x45°
6	特大卡式軸承 OVERSIZE CARTRIDGE BALL BEARING	軸承鋼 SUJ2	ACB-518 (397)	1	OD51.8x36°x45°
7	鋁下塞 CROWN RACE	鋁合金 7075/T6	397-6	1	ø39.8(ø30)±0.1

- 全隱藏式車頭碗組
- 1.5" 轉1-1/8" 前叉立管
- 車頭管外徑上小下大
(建議車頭管外徑上半部46mm, 下半部56mm)
- 鋁合金(6061)上塞
- 鋁合金(7075)下塞(內徑39.8mm或30mm)
- 上半部:密封式軸承
下半部:特大型卡式軸承

- Full-integrated headset
- For 1-1/8" upper, 1.5" bottom steerer
- For different outerdiameter head tube
- 6061/T6 cnc machined top cover with seals
- 7075/T6 cnc machined crown race
(inner diameter 39.8mm or 30mm)
- Upper:angular contact sealed bearing
Lower:super oversize cartridge ball bearing

單位 UNIT	mm	比例 SCALE	1:1	日期 DRAWING DATE	2019.01.10	角法 VIEW	
型號 ITEM NO.	H397/H397M/H397H						版次(REV):A
品名 ITEM NAME	H397/H397M/H397H 組立圖(Assembly Drawing)						
規格 DIMENSION	1-1/8" x42x52x39.8(30)						
圖號 FIG. NO.	H397(H397M/H397H)-組立圖-A						
編號 NO.	更改內容(MODIFIED RECORD)		更改者 MODIFIER	修改日期 MODIFIED DATE			
製圖 DRAWER	洪明碩	審核 PROOFREAD	核准 APPROBATION				



誌慶工業股份有限公司